

**WARNING:**  
CHOKING HAZARD—Small parts.  
Not for children under 3 years.

**AGES 4+**  
20850

## THE RISE OF BOBA FETT™

### ASSEMBLY

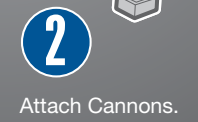
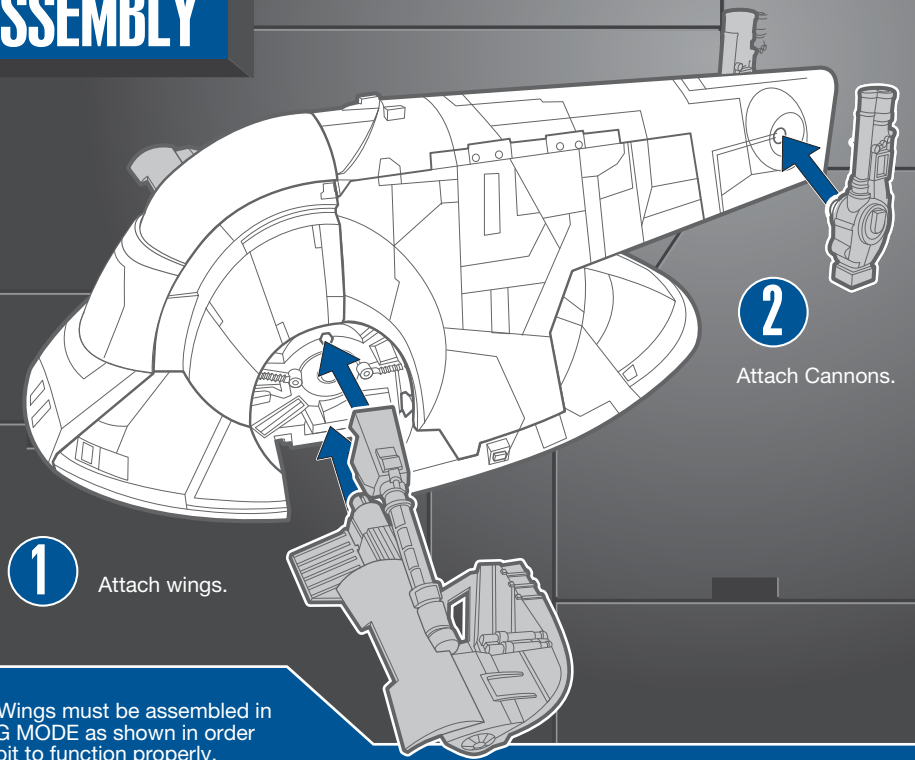

**NOTE:** Wings must be assembled in LANDING MODE as shown in order for cockpit to function properly.

### PEEL AND APPLY LABELS AS SHOWN

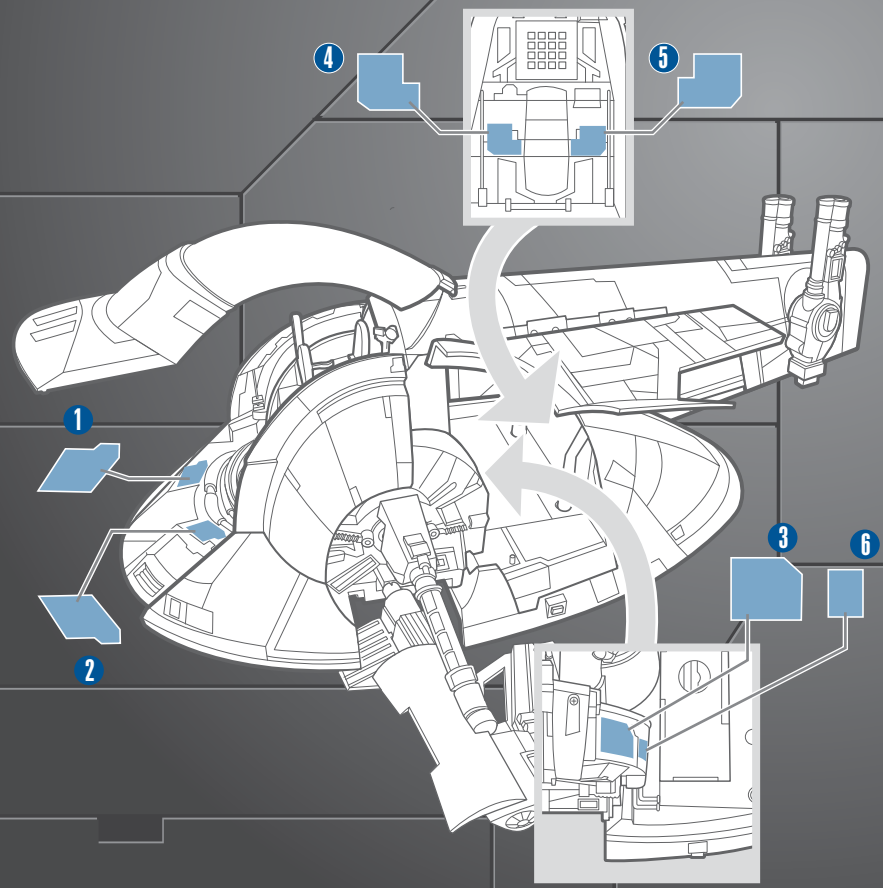

### FEATURES

PIVOT WINGS FOR LANDING OR FLIGHT MODE.

LANDING:

FLIGHT:

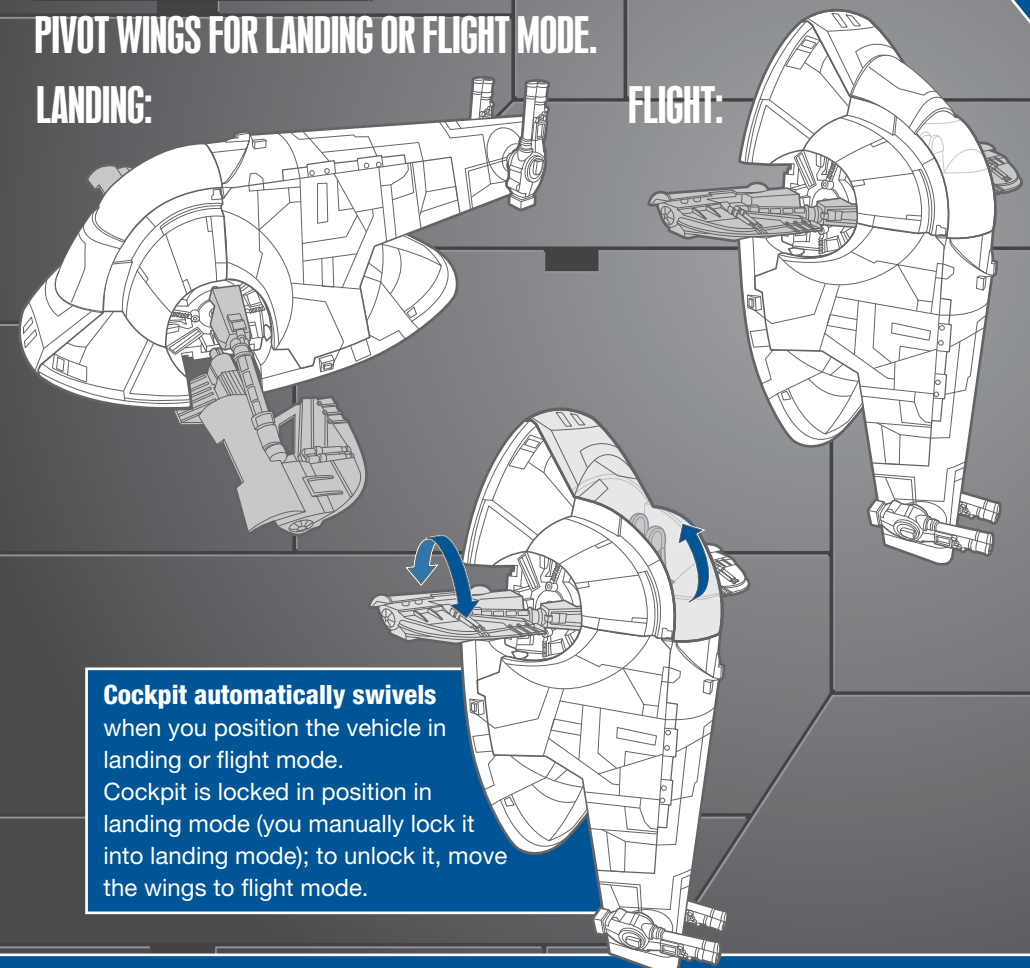

# FEATURES

## TO LOAD AND LAUNCH CANNONS:

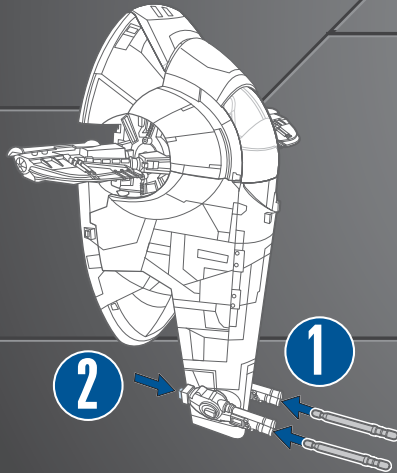

Cannons rotate 360 degrees.

## TO LOAD AND LAUNCH BOMBS:

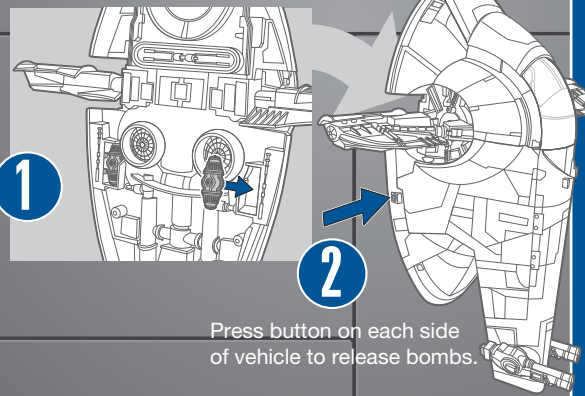

Press button on each side of vehicle to release bombs.

**NOTE:** JEDI STARFIGHTER's missiles can not be fired by SLAVE 1's cannons.

## FORWARD CARGO BAY:

Lift cockpit canopy to access bay.

## WALKWAY AND STORAGE COMPARTMENT:

Slide walkway out.

## DETENTION CELL:

1 Lower ramp.

2 Place figure in cell and cover with top.

3

Place cell on ramp. Lift ramp into place. The cell can also be used to store accessories.

## JEDI STARFIGHTER FEATURES:

Hold rear section of starfighter and pull front section forward to separate the two sections. The wings on the front section will automatically open as you separate the vehicle.

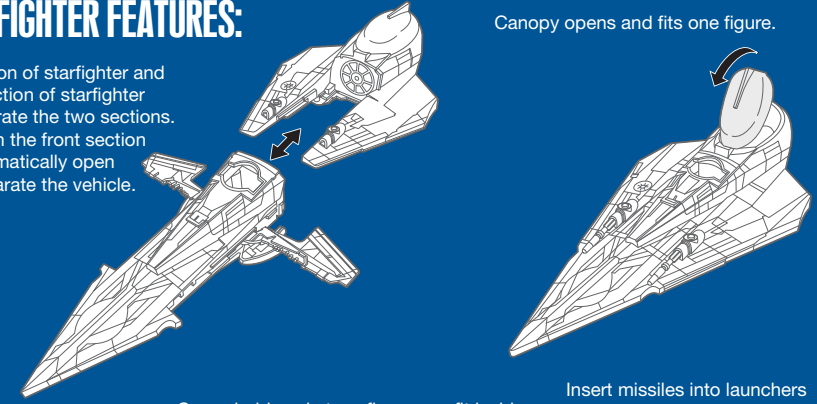

Canopy opens and fits one figure.

Droid fits in droid socket.

Open droid socket – a figure can fit inside.

Insert missiles into launchers and press buttons to fire.

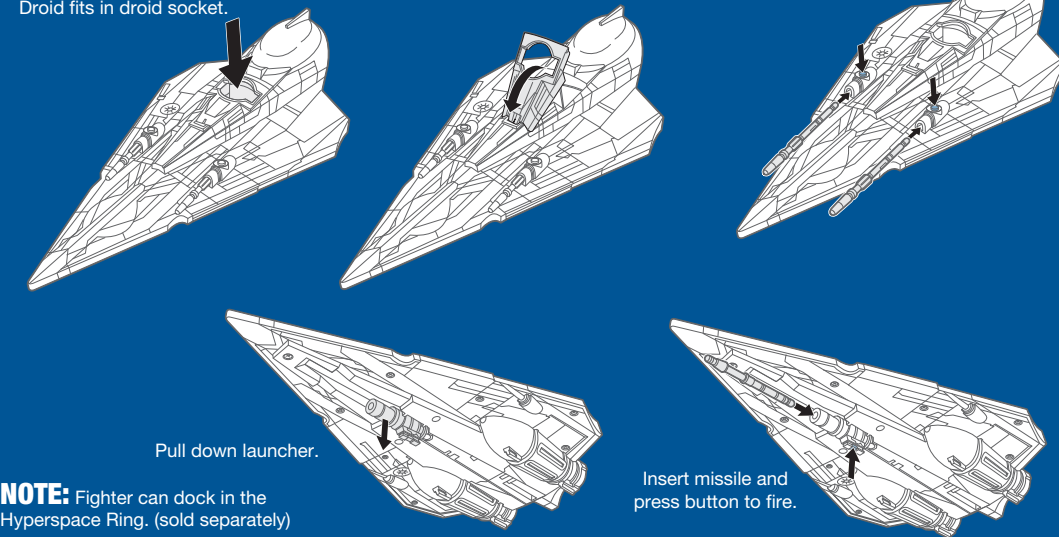

**NOTE:** Fighter can dock in the Hyperspace Ring. (sold separately)



Some poses may require additional support. Product and colors may vary. © 2010 Lucasfilm Ltd. & © or TM where indicated. All rights reserved. ® and/or TM\* & © 2010 Hasbro. All Rights Reserved. TM & © denote U.S. trademarks. PN: 7060810000



Not suitable for children under 3 years because of small parts — choking hazard.